

IMPROVEMENT PLANS FOR:

# WASTEWATER TREATMENT PLANT ROAD STABILIZATION

CITY OF WATERFORD, CALIFORNIA

PROJECT LIMITS

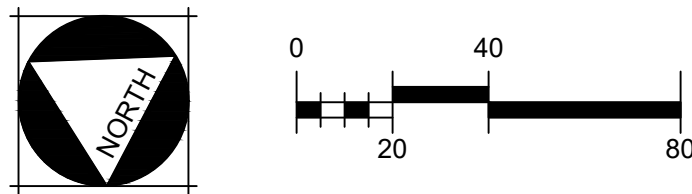

MONUMENT PRESERVATION

1. CONTRACTOR SHALL PRESERVE AND PROTECT EXISTING MONUMENTS, REFERENCED IN THESE IMPROVEMENT PLANS. IN THE EVENT THAT A MONUMENT MUST BE REMOVED, CONTRACTOR SHALL BE REQUIRED TO INSTALL A NEW MONUMENT BOX. CONTRACTOR SHALL REQUEST MONUMENT STAKING 48 HOURS PRIOR TO INSTALLATION OF NEW MONUMENT BOXES.
2. IF A MONUMENT IS DISCOVERED DURING CONSTRUCTION, THE CONTRACTOR SHALL NOTIFY THE CITY ENGINEER IMMEDIATELY, AND SHALL BE RESPONSIBLE FOR THE PRESERVATION OF THAT MONUMENT.

PUBLIC WORKS PERSONNEL

LONNIE STATZER  
PUBLIC WORKS DIRECTOR  
(C): 209-226 - 0929

STEPHANIE MENDES  
WWTP OPERATOR  
(C): 209 564 - 0765

SHEET INDEX

- |   |                              |
|---|------------------------------|
| 1 | COVER SHEET                  |
| 2 | GENERAL NOTES                |
| 3 | TOPOGRAPHY & DEMOLITION PLAN |
| 4 | GRADING PLAN                 |
| 5 | EROSION CONTROL PLAN         |

VICINITY MAP

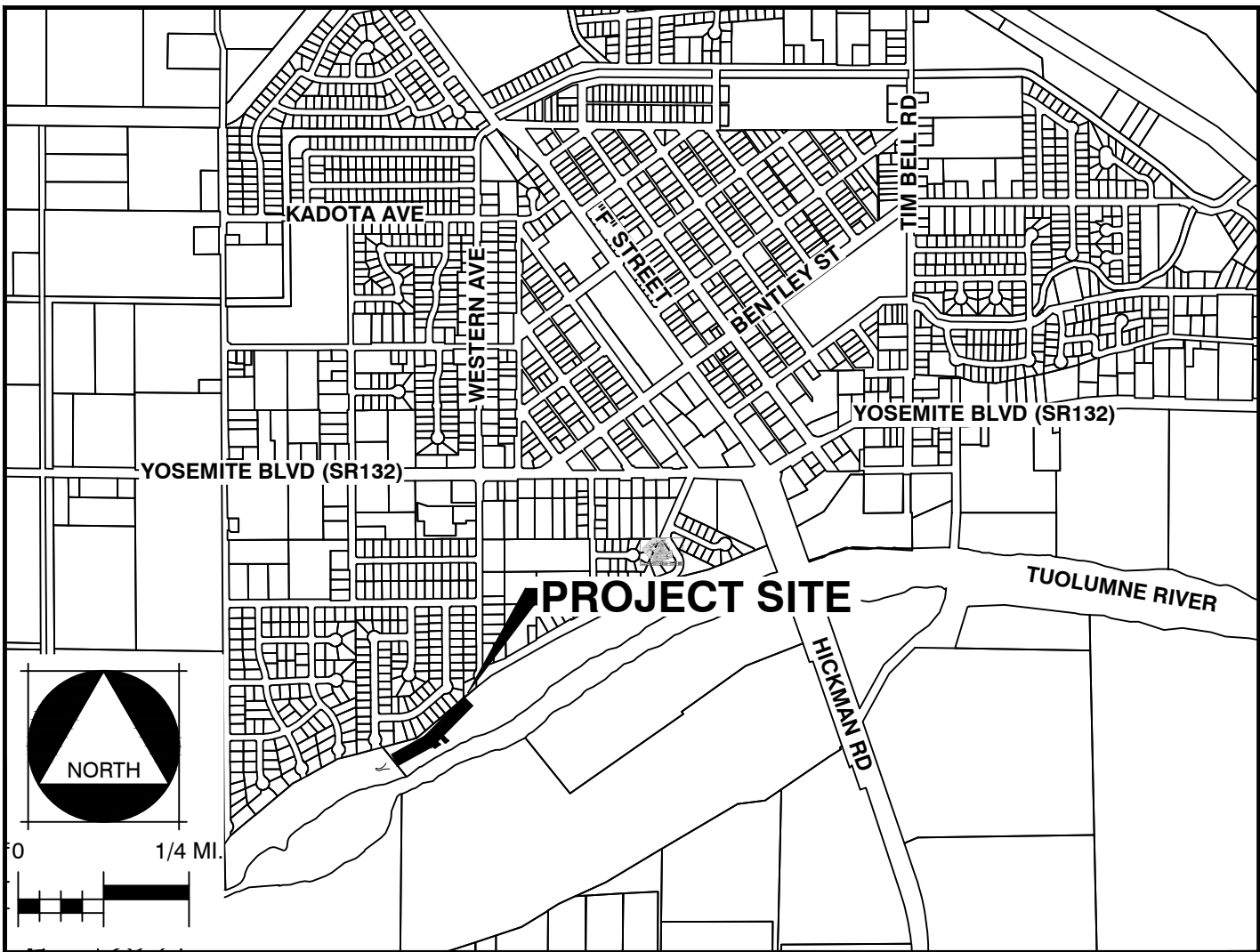

PUBLIC WORKS PROJECT

**CITY OF WATERFORD**

320 E STREET WATERFORD, CA 95366

MCR ENGINEERING, INC.

1242 DUPONT COURT  
MANTACA, CA 95336

TEL : (209) 239 - 6229  
FAX : (209) 239 - 8839

PREPARED UNDER THE DIRECTION OF:

ROBERT B. MARLER R.C.E. C70159 EXP. 9-30-24 DATE

PLAN REVISIONS		DATE
NO	DESCRIPTIONS	
1		
2		
3		
4		
5		
6		
7		

JOB NO. 23-01	DATE 5/16/2024
SCALE AS SHOWN	DR BY NS
CK BY RM	FILE: WaterfordPublic23-01

COVER SHEET

WWTP ROAD STABILIZATION

CALIFORNIA WATERFORD



Know what's below.  
Call before you dig.  
811 / 800-227-2600



GENERAL NOTES:

- ALL IMPROVEMENTS SHALL BE CONSTRUCTED IN STRICT ACCORDANCE WITH THE FOLLOWING: CITY OF OAKDALE STANDARD SPECIFICATIONS, AND ALL AMENDMENTS TO DATE, CALIFORNIA DEPARTMENT OF TRANSPORTATION STANDARD SPECIFICATIONS (CALTRANS, LATEST EDITION), WHERE APPLICABLE. ALL WORK SHALL BE UNDER THE INSPECTION OF THE RESPECTIVE ENTITY.
- IT IS INTENDED THAT THESE PLANS AND SPECIFICATIONS REQUIRE ALL LABOR AND MATERIALS NECESSARY AND PROPER FOR THE WORK CONTEMPLATED AND THAT THE WORK BE COMPLETED IN ACCORDANCE WITH THEIR TRUE INTENT AND PURPOSE. THE CONTRACTOR SHALL NOTIFY THE ENGINEER IMMEDIATELY REGARDING ANY DISCREPANCIES AND AMBIGUITIES WHICH MAY EXIST IN THE PLANS AND SPECIFICATIONS. IF THE PLANS OR SPECIFICATIONS DESCRIBE PORTIONS OF THE WORK IN GENERAL TERMS BUT NOT IN COMPLETE DETAIL, IT IS UNDERSTOOD THAT ONLY THE BEST GENERAL PRACTICE IS TO PREVAIL AND THAT ONLY MATERIALS AND WORKMANSHIP OF THE FIRST QUALITY ARE TO BE USED.
- CONSTRUCTION STAKING FOR GRADING, CURB, GUTTER, AND SIDEWALK, STORM DRAIN AND WATER SHALL BE DONE UNDER THE DIRECTION OF M.C.R. ENGINEERING. THE CONTRACTOR SHALL NOTIFY THE ENGINEER SEVENTY-TWO (72) HOURS IN ADVANCE OF THIS NEED FOR STAKING. ANY STAKING REQUESTED BY THE CONTRACTOR OR HIS SUBCONTRACTORS THAT IS ABOVE AND BEYOND NORMAL STAKING NEEDS, WILL BE SUBJECT TO AN EXTRA BACK CHARGE TO THE CONTRACTOR.
- THE CONTRACTOR SHALL EXERCISE DUE CAUTION AND SHALL CAREFULLY PRESERVE BENCH MARKS, REFERENCE POINTS AND ALL SURVEY STAKES, AND SHALL BEAR ALL EXPENSE FOR REPLACEMENT AND/OR ERRORS CAUSED BY THEIR UNNECESSARY LOSS OR DISTURBANCE. ALL CENTERLINE AND/OR SURVEY MONUMENTS SHALL BE PRESERVED OR RESET AT THE END OF CONSTRUCTION.
- CONTRACTOR AGREES THAT HE SHALL ASSUME SOLE AND COMPLETE RESPONSIBILITY FOR JOB SITE CONDITIONS DURING THE COURSE OF CONSTRUCTION OF THIS PROJECT, INCLUDING SAFETY OF ALL PERSONS AND PROPERTY; THAT THIS REQUIREMENT SHALL APPLY CONTINUOUSLY AND NOT BE LIMITED TO NORMAL WORKING HOURS; AND THAT THE CONTRACTOR SHALL DEFEND, INDEMNIFY AND HOLD THE OWNER, ENGINEER AND THE CITY HARMLESS FROM ANY AND ALL LIABILITY, REAL OR ALLEGED, IN CONNECTION WITH THE PERFORMANCE OF WORK ON THIS PROJECT, EXCEPTING FOR LIABILITY ARISING FROM THE SOLE NEGLIGENCE OF THE OWNER OR THE ENGINEER.
- UNLESS OTHERWISE STATED, ALL STATIONS INDICATED ON THE IMPROVEMENT PLANS ARE REFERENCED TO THE CENTERLINE OF THE STREET. ALL STATIONS OFF CENTER ARE PERPENDICULAR TO OR RADIALLY OPPOSITE CENTERLINE STATIONS, UNLESS OTHERWISE NOTED.
- THE CONTRACTOR SHALL BE HELD RESPONSIBLE FOR ANY FIELD CHANGES MADE WITHOUT WRITTEN AUTHORIZATION FROM THE CITY ENGINEER.
- THE CONTRACTOR SHALL PROVIDE ALL LIGHTS, SIGNS, BARRICADES, FLAG MAN OR OTHER DEVICES NECESSARY FOR PUBLIC SAFETY IN ACCORDANCE WITH THE CURRENT ISSUE OF "MANUAL OF TRAFFIC CONTROLS, WARNING SIGNS, LIGHTS AND DEVICES FOR USE IN PERFORMANCE OF WORK UPON HIGHWAY" PUBLISHED BY THE STATE OF CALIFORNIA BUSINESS AND TRANSPORTATION AGENCY.
- THE OFFICE OF THE CITY ENGINEER SHALL BE NOTIFIED AT LEAST 24 HOURS IN ADVANCE OF ANY WORK.
- THE CITY OF OAKDALE AND ASSOCIATED UTILITY COMPANIES AND RESIDENCES TO BE AFFECTED SHALL BE NOTIFIED IMMEDIATELY UPON ANY UTILITY SERVICE DISRUPTION OTHER THAN SPECIFIED ON THESE IMPROVEMENT PLANS AND A 24 HOUR NOTICE SHALL BE GIVEN FOR ANY PLANNED DISRUPTION.
- THE CONTRACTOR SHALL OBTAIN AN ENCROACHMENT PERMIT FROM THE CITY OF OAKDALE, DEPARTMENT OF PUBLIC WORKS OR ANY OTHER APPLICABLE AGENCIES PRIOR TO COMMENCEMENT OF WORK WITHIN EXISTING CITY RIGHT-OF-WAY. THE CONTRACTOR SHALL BE RESPONSIBLE FOR ALL PERMITS AND LICENSES REQUIRED FOR THE CONSTRUCTION AND COMPLETION OF THE PROJECT.
- STREET SIGNS, TRAFFIC CONTROL SIGNS, AND PAVEMENT MARKINGS SHALL BE PROVIDED AND INSTALLED BY THE CONTRACTOR AT LOCATIONS ESTABLISHED BY THE ENGINEER.
- ASPHALT CONCRETE SHALL BE PLACED ONLY WHEN THE ATMOSPHERIC TEMPERATURE IS ABOVE 50°F.
- CONTRACTOR IS RESPONSIBLE FOR COORDINATION OF THE REMOVAL OR RELOCATION OF ALL EXISTING UTILITIES WITH RESPECTIVE UTILITY COMPANIES.
- DRIVEWAYS IMPACTED DURING CONSTRUCTION SHALL BE RESTORED TO THEIR ORIGINAL STATE.
- DRAWING NUMBERS SHOWN ON THE PLANS REFER TO DRAWINGS CONTAINED IN THE CITY OF OAKDALE STANDARD SPECIFICATIONS, THUS: (I.E. DWG. 5-H-3).
- PRIOR TO COMMENCING ANY WORK, IT SHALL BE THE CONTRACTOR'S RESPONSIBILITY TO HAVE EACH UTILITY COMPANY LOCATE, IN THE FIELD, THEIR MAIN AND SERVICE LINES. THE CONTRACTOR SHALL NOTIFY MEMBERS OF THE UNDERGROUND SERVICE ALERT (U.S.A.) 48 HOURS IN ADVANCE OF PERFORMING ANY EXCAVATION WORK BY CALLING THE TOLL-FREE NUMBER (800) 227-2600. THE CONTRACTOR SHALL RECORD THE U.S.A. ORDER NUMBER AND FURNISH ORDER NUMBER TO OWNER PRIOR TO ANY EXCAVATION. IT SHALL BE THE CONTRACTOR'S SOLE RESPONSIBILITY TO PROTECT ALL EXISTING UTILITIES SO THAT NO DAMAGE RESULTS TO THEM DURING THE PERFORMANCE OF THIS CONTRACT. ANY REPAIRS NECESSARY TO DAMAGED UTILITIES SHALL BE PAID FOR BY THE CONTRACTOR. THE CONTRACTOR SHALL BE REQUIRED TO COOPERATE WITH OTHER CONTRACTORS' AND UTILITY COMPANIES INSTALLING NEW STRUCTURES, UTILITIES AND SERVICE TO THE DEVELOPMENT.
- THE CONTRACTOR SHALL BE RESPONSIBLE FOR PROTECTING EXISTING IMPROVEMENTS FROM DAMAGE. COST OF REPLACING EXISTING IMPROVEMENTS SHALL BE INCLUDED IN THE UNIT PRICE BID FOR ITEMS REQUIRING REMOVAL AND REPLACEMENT OF EXISTING IMPROVEMENTS.
- WHENEVER PAVEMENT IS BROKEN OR CUT IN THE INSTALLATION OF THE WORK COVERED BY THESE SPECIFICATIONS, THE PAVEMENT SHALL BE REPLACED, AFTER PROPER BACKFILLING, WITH PAVEMENT MATERIALS EQUAL TO OR BETTER THAN THE MATERIALS USED IN THE ORIGINAL PAVING. THE FINISHED PAVEMENT SHALL BE SUBJECT TO THE APPROVAL OF THE CITY ENGINEER, OR CALTRANS, WHERE APPLICABLE.
- PAYMENT FOR PAVEMENT WILL BE MADE ONLY FOR AREAS SHOWN ON THE PLANS REPLACEMENT OF PAVEMENT WHICH IS BROKEN OR CUT DURING THE INSTALLATION OF THE WORK COVERED BY THESE SPECIFICATIONS, AND WHICH LIES OUTSIDE OF SAID AREAS, SHALL BE INDICATED IN THE CONTRACTOR'S UNIT PRICE FOR PAVEMENT, AND NO ADDITIONAL PAYMENT SHALL BE MADE FOR SUCH WORK.
- EXCAVATIONS OF 5 FEET OR MORE IN DEPTH WILL REQUIRE AN EXCAVATION PERMIT FROM THE STATE OF CALIFORNIA DEPARTMENT OF INDUSTRIAL SAFETY. FOR TRENCHES 5 FEET OF MORE IN DEPTH, THE CONTRACTOR SHALL COMPLY WITH SECTION 5-1.02A OF THE CALTRANS STANDARDS, CHAPTER 9 OF THE STATE OF CALIFORNIA LABOR CODE, AND ANY LOCAL CODES OR ORDINANCES.
- WE CALL YOUR ATTENTION TO TITLE 8 CALIFORNIA ADMINISTRATION CODE SECTION 1540 (A) (1) OF THE CONSTRUCTION SAFETY ORDERS ISSUED BY THE

OCCUPATIONAL SAFETY AND HEALTH STANDARDS BOARD PURSUANT TO THE CALIFORNIA OCCUPATIONS SAFETY AND HEALTH ACT OF 1973 AS AMENDED WHICH STATES: (1) PRIOR TO OPENING AN EXCAVATION EFFORT SHALL BE MADE TO DETERMINE WHETHER UNDERGROUND INSTALLATIONS, I.E. SEWER, WATER, FUEL, ELECTRICAL LINES, ETC., WILL BE ENCOUNTERED AND IF SO, WHERE SUCH UNDERGROUND INSTALLATIONS ARE LOCATED. WHEN THE EXCAVATION APPROACHES THE APPROXIMATE LOCATION OF SUCH INSTALLATION, THE EXACT LOCATION SHALL BE DETERMINED BY CAREFUL PROBING OR HAND DIGGING; AND, WHEN IT IS UNCOVERED, ADEQUATE PROTECTION SHALL BE PROVIDED FOR THE EXISTING INSTALLATION. ALL KNOWN OWNERS OF UNDERGROUND FACILITIES IN THE AREA CONCERNED SHALL BE ADVISED OF PROPOSED WORK AT LEAST 48 HOURS PRIOR TO THE START OF ACTUAL EXCAVATION.

- ALL TRENCHES ON MAJOR AND COLLECTOR STREETS AND CROSS TRENCHES ON ALL STREETS SHALL BE PAVED WITH TEMPORARY PAVING THE SAME DAY THE PAVEMENT CUT IS MADE.
- APPROPRIATE DUST CONTROL SHALL BE PROVIDED, AT THE CONTRACTOR'S EXPENSE TO MINIMIZE ANY DUST NUISANCE AND SHALL BE IN ACCORDANCE WITH SECTION 10 OF CALTRANS STANDARD SPECIFICATIONS AND THE REQUIREMENTS OF THE CITY OF OAKDALE.
- THE CONTRACTOR SHALL SUBMIT TO THE ENGINEER, PRIOR TO FINAL ACCEPTANCE, AS-BUILT DRAWINGS OF ALL IMPROVEMENTS REPRESENTED BY THE PROJECT PLANS AND SPECIFICATIONS.
- AFTER CONSTRUCTION OF ALL IMPROVEMENTS, THE ENGINEER SHALL SUBMIT ONE SET OF REPRODUCIBLE PLANS, FINAL INVERT ELEVATIONS FOR SEWER AND STORM DRAIN LINES THAT ARE TO BE EXTENDED FOR FUTURE CONSTRUCTION SHALL ALSO BE SHOWN ON THE "AS-BUILT" PLANS ALL AS PROVIDED TO THE ENGINEER BY THE CONTRACTOR.
- THE CONTRACTOR SHALL NOTIFY M.C.R. ENGINEERING AT LEAST 48 HOURS PRIOR TO BACKFILLING OF ANY PIPE WHICH STUBS TO A FUTURE PHASE OF CONSTRUCTION FOR INVERT VERIFICATION. TOLERANCE SHALL BE IN ACCORDANCE WITH THE CITY OF OAKDALE STANDARD SPECIFICATIONS.
- REGULATING DISCHARGES OF STORM WATER ASSOCIATED WITH CONSTRUCTION ACTIVITY FROM SOIL DISTURBANCES OF ONE (1) ACRE OR MORE, A NOTICE OF INTENT (NOI) TO COMPLY WITH THE TERMS OF THE GENERAL PERMIT TO DISCHARGE STORM WATER ASSOCIATED WITH CONSTRUCTION ACTIVITY MUST BE FILED AND APPROPRIATE FEE PAID PRIOR TO COMMENCEMENT OF CONSTRUCTION IN ADDITION, AT THE CONCLUSION OF THE PROJECT A NOTICE OF TERMINATION MUST ALSO BE FILED, SUBMIT THE FEE, A NOTICE OF INTENT, AND NOTICE OF TERMINATION TO THE STATE RESOURCES CONTROL BOARD AT THE FOLLOWING ADDRESS:

STATE WATER RESOURCES CONTROL BOARD  
P.O. BOX 100  
SACRAMENTO, CA 95812-0100  
ATTN: STORM WATER PERMITTING SECTION

- IF YOU HAVE ANY QUESTIONS CALL WATER QUALITY CONTROL ENGINEER, CALIFORNIA REGIONAL WATER QUALITY CONTROL BOARD, CENTRAL VALLEY REGION AT (916) 464-3291.
- THE CONTRACTOR SHALL COMPLY WITH THE REQUIREMENTS OF THE STATE WATER RESOURCES CONTROL BOARD (SWCRB) ORDER NO. 2009-0009-DWQ. THE CONTRACTOR SHALL IMPLEMENT AND MONITOR A STORM WATER POLLUTION PREVENTION PLAN (SWPPP) IN ACCORDANCE WITH THE SWRCB REGULATIONS.
- CONTRACTOR SHALL COMPLY WITH BUSINESS AND PROFESSIONS CODE, SECTION 8771 (b) REGARDING REFERENCING, PRESERVING, AND RECONSTRUCTING MONUMENTS, WHETHER OR NOT THE MONUMENTS ARE SHOWN ON THE PLANS.

GRADING NOTES:

- EARTHWORK SHALL BE PERFORMED IN ACCORDANCE WITH THE CITY OF OAKDALE STANDARDS. ALL FILL AREAS SHALL BE TESTED AS REQUIRED BY THE CITY OF OAKDALE AND SHALL BE PAID FOR BY THE CONTRACTOR.
- THE CITY SHALL BE RESPONSIBLE FOR COST OF INITIAL TEST FOR MOISTURE DENSITY CURVE. IF THE FIRST TEST FAILS, THE CONTRACTOR SHALL BE RESPONSIBLE FOR COST OF ALL SUBSEQUENT CURVES AND TESTS.
- THE CONTRACTOR SHALL REVIEW SITE PRIOR TO BIDDING. ALL VEGETATION AND DELETERIOUS MATERIALS, INCLUDING ROOTS SHALL BE REMOVED FROM THE SITE AT THE EXPENSE OF THE CONTRACTOR AND SHALL BE INCLUDED IN THE LUMP SUM CLEARING COST.
- THE CONTRACTOR SHALL PRESERVE ALL STAKES AND POINTS SET FOR LINES, GRADES OR MEASUREMENT OF THE WORK IN THEIR PROPER PLACES UNTIL AUTHORIZED TO REMOVE THEM BY THE ENGINEER. ALL EXPENSES INCURRED IN REPLACING STAKES THAT HAVE BEEN REMOVED WITHOUT PROPER AUTHORITY SHALL BE PAID FOR BY THE GENERAL CONTRACTOR.
- CONTRACTOR SHALL OBTAIN 95% RELATIVE COMPACTION IN ALL GRADED AREAS.

POLLUTION AND DUST NOTES:

- THE CONTRACTOR SHALL KEEP THE WORK SITE FREE AND CLEAR OF RUBBISH AND DEBRIS.
- THE CONTRACTOR SHALL EXERCISE CARE TO PRESERVE AND PROTECT NATURAL HABITAT ADJACENT TO THE PROJECT SITE.
- THE CONTRACTOR SHALL NOT DISCHARGE SMOKE, DUST, OR ANY OTHER AIR CONTAMINANTS INTO THE ATMOSPHERE IN SUCH A QUANTITY AS WILL VIOLATE THE REGULATIONS OF ANY LEGALLY CONSTITUTED AUTHORITY.
- THE CONTRACTOR SHALL KEEP ALL AREAS GENERATING DUST WITHIN THE LIMITS OF THE PROJECT WELL WATERED DURING THE TERM OF THIS CONTRACT. THIS INCLUDES BUT IS NOT LIMITED TO ACCESS RAMPS, THE HAUL ROADS, THE EMBANKMENT FILL AREA, AND ANY OTHER AREAS THAT MAY GENERATE DUST AS A RESULT OF CONTRACTOR'S OPERATIONS. THE CONTRACTOR SHALL PROVIDE DUST CONTROL MEASURES DURING EVENINGS, WEEKENDS, AND HOLIDAYS WHEN REQUESTED BY THE DISTRICT AT NO ADDITIONAL COST TO THE DISTRICT.
- THE CONTRACTOR(S) SHALL KEEP ALL PUBLIC ROADWAYS ADJACENT TO THE PROJECT SITE FREE AND CLEAR OF MUD AND SILT DURING THE TERM OF THIS CONTRACT. THIS INCLUDES MUD CAUSED BY RAIN OR BY THE CONTRACTOR(S) WATERING PROCEDURES FOR DUST CONTROL.
- THROUGHOUT ALL PHASES OF CONSTRUCTION, INCLUDING SUSPENSION OF WORK, AND UNTIL FINAL ACCEPTANCE OF THE PROJECT, THE CONTRACTOR SHALL KEEP THE PREMISES OCCUPIED BY HIM IN A CLEAN AND ORDERLY CONDITION, DISPOSING OF REFUSE AND LITTER IN A MANNER SATISFACTORY TO THE CITY OF OAKDALE.

LEGEND

ITEM	EXISTING	PROPOSED
WATER VALVE		
WATER HOSE BIB		
AIR RELEASE VALVE		
BLOWOFF		
FIRE HYDRANT		
WATER METER		
IRRIGATION BOX		
SEWER MANHOLE		
STORM MANHOLE		
DRAIN INLET		
CURB INLET		
CLEANOUT		
WATER LINE		
SANITARY SEWER		
STORM DRAIN		
TYPICAL ELECTROLIER		
TYPICAL LUMINAIRE		
ELECTRICAL VAULT		
SURVEY MONUMENT		
UTILITY POLE		
SIGNAGE		
LINE STOP		
ELEVATION		
DIRECTION OF FLOW		
ORIGINAL GROUND		N/A
CONTOUR (0.5' INTERVAL)		N/A
BARBED WIRE FENCE		
MASONRY WALL		
CHAIN LINK FENCE		
WOOD FENCE		
CURB, GUTTER & SIDEWALK		
TYPICAL RETURN WITH HANDICAP RAMP		
TREE		N/A
PAVEMENT		



Know what's below.  
Call before you dig.  
811 / 800-227-2600

PLAN REVISIONS		DATE
NO	DESCRIPTIONS	
1		
2		
3		
4		
5		
6		
7		
8		
9		
10		

JOB NO. 23-01	DATE 5/16/2024
SCALE AS SHOWN	DR BY NS
CK BY RM	FILE: WaterfordPublic23-01

GENERAL NOTES

WWTP ROAD STABILIZATION

SHEET

2

OF 5 SHEETS

TOPOGRAPHY & DEMOLITION PLAN

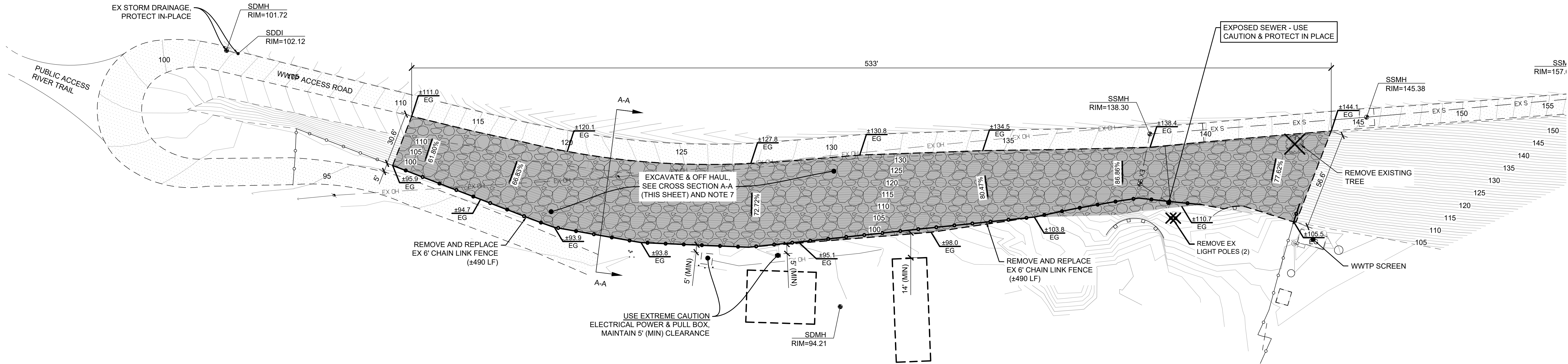
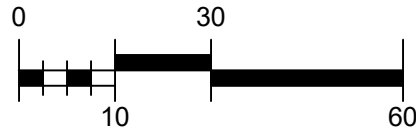
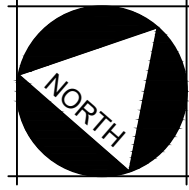

NOTES

- THE LOCATION OF EXISTING UTILITIES ARE SHOWN FROM RECORD DRAWINGS & FIELD SURVEY INFORMATION. PRIOR TO CONSTRUCTION THE CONTRACTOR SHALL VERIFY THE LOCATION OF ALL UTILITIES INCLUDING THOSE NOT SHOWN ON THESE PLANS. NOTIFY THE ENGINEER OF ANY DISCREPANCIES OR CONFLICTS AS SOON AS ENCOUNTERED. POT HOLE EXISTING UTILITIES PRIOR TO CONSTRUCTION. CONTRACTOR SHALL COORDINATE WITH DISTRICT STAFF TO DETERMINE IF UTILITIES CAN BE REMOVED OR IF THEY NEED TO BE RE-ROUTED.
- UNLESS OTHERWISE IDENTIFIED ALL EXISTING FACILITIES SHOWN IN THE TOPOGRAPHIC AND DEMO PLAN ARE TO BE PRESERVED AND PROTECTED DURING CONSTRUCTION. CONTACT DESIGN ENGINEER IF FACILITIES SHOWN TO REMAIN COME IN CONFLICT WITH PROPOSED IMPROVEMENTS.
- ALL EXISTING UTILITIES WERE PLOTTED FROM RECORD INFORMATION AND FIELD TOPOGRAPHY. ACTUAL LOCATIONS MAY VARY AND ADDITIONAL CROSSINGS MAY EXIST IN THE FIELD. IT IS IMPERATIVE THAT "U.S.A." LOCATION SERVICES ARE LOCATED AND MARKED PRIOR TO START OF EXCAVATION.
- THE CONTRACTOR SHALL USE EXTREME CAUTION WHEN EXPOSING EXISTING UTILITY CROSSINGS AND SERVICES.
- ANY DAMAGE TO EXISTING UTILITIES WILL BE SOLE RESPONSIBILITY OF THE CONTRACTOR.
- EXISTING ELECTRICAL UTILITIES SHALL HAVE A CONSISTENT CLEARANCE.
- EXCAVATION, GEO FABRIC INSTALL AND ROCK PLACEMENT SHALL TAKE PLACE IN 40' SEGMENTS. FULLY LOADED TRUCKS (I.E. "10-WHEELERS", "SUPERS", OR SIMILAR) SHALL NOT BE PERMITTED TO UTILIZE THE ACCESS ROAD BETWEEN START OF EXCAVATION AND FINISH OF ROCK PLACEMENT FOR EACH 40' SEGMENT. MATERIALS SHOULD BE STAGED APPROPRIATELY TO ACCOMMODATE THE LIMITED ACCESS. ANY SETTLING OR FAILURE OF THE ACCESS ROAD ASPHALT THAT OCCURS FROM UNAPPROVED TRUCK MOVEMENTS SHALL BE THE RESPONSIBILITY OF THE CONTRACTOR AND SHALL REQUIRE REMOVAL OF THE ACCESS ROAD AT THE LOCATION OF THE FAILURE, OVER EXCAVATION, AND COMPACTED BACKFILL.

LEGEND

- EXISTING PAVEMENT TO REMAIN
- REMOVE SOIL & DEBRIS (SEE BID QUANTITIES)
- DEMOLITION LIMITS

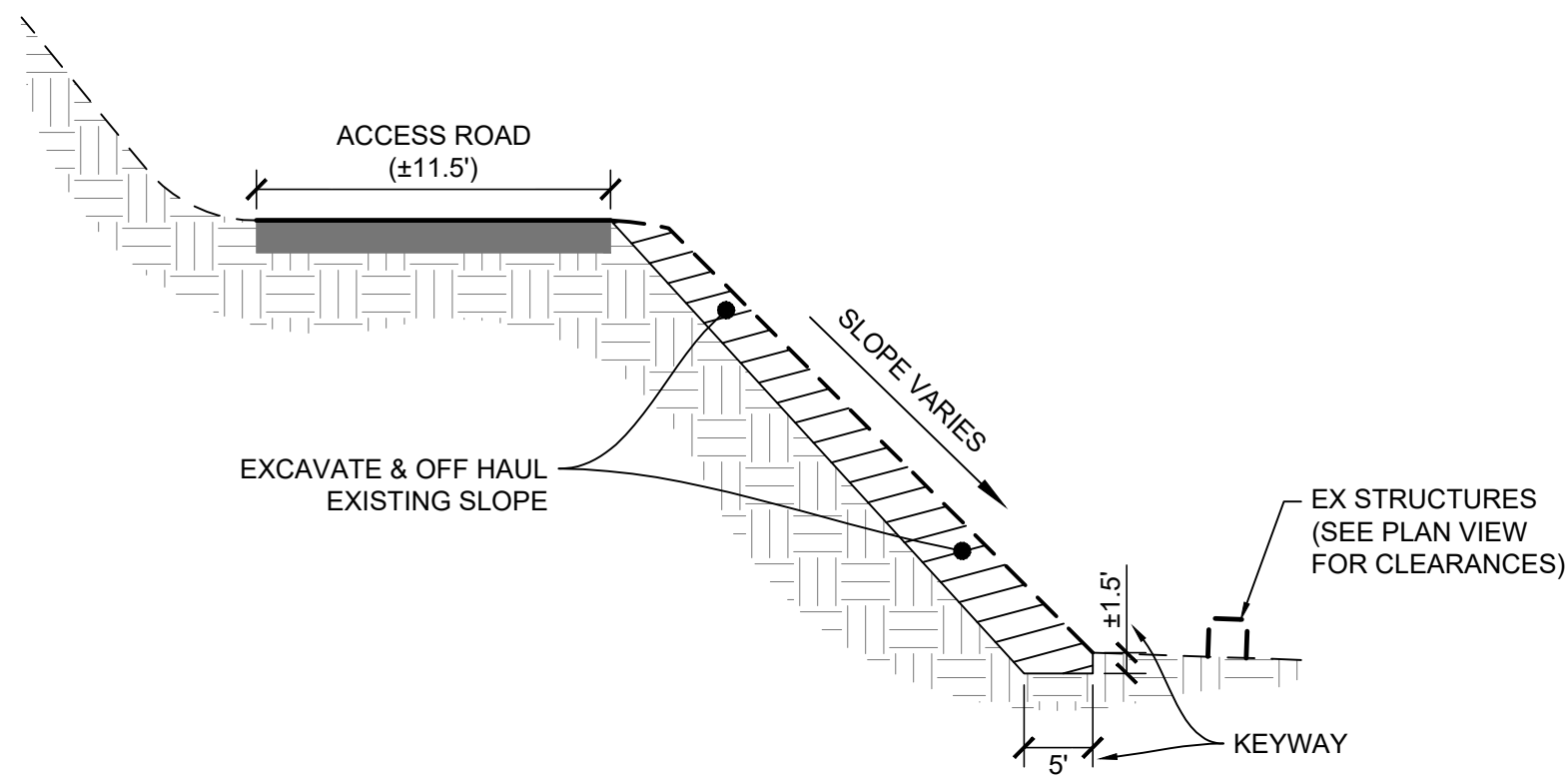

A  
A  
TYPICAL EX CROSS SECTION  
NOT TO SCALE



Know what's below.  
Call before you dig.  
811 / 800-227-2600

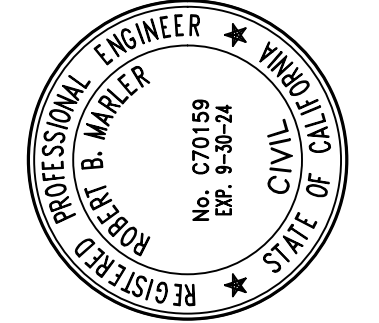

MCR ENGINEERING, INC.  
1242 DUPONT COURT  
MANTENCA, CA 95336  
TEL : (209) 239-6229  
FAX : (209) 239-8839  
PREPARED UNDER THE DIRECTION OF:  
ROBERT B. MARLER R.C.E. C70159 EXP. 9-30-24 DATE

PLAN REVISIONS	
NO	DESCRIPTIONS
1	
2	
3	
4	
5	
6	
7	

JOB NO.	23-01
DATE	5/16/2024
SCALE	AS SHOWN
DR BY	NS
CK BY	RM
FILE:	WaterfordPublic23-01

TOPOGRAPHY & DEMOLITION PLAN

WWTP ROAD STABILIZATION

CALIFORNIA

WATERFORD,

SHEET

3

OF 5 SHEETS



GRADING PLAN

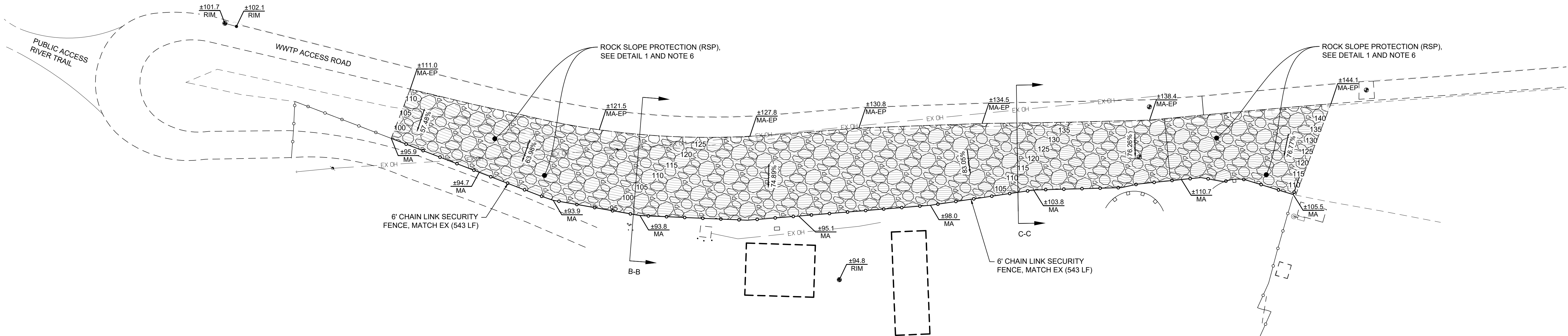
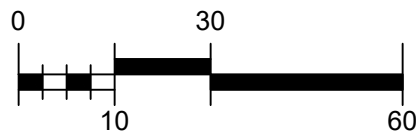
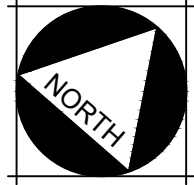

NOTES

- ALL EXISTING UTILITIES WERE PLOTTED FROM RECORD INFORMATION AND FIELD TOPOGRAPHY. ACTUAL LOCATIONS MAY VARY AND ADDITIONAL CROSSINGS MAY EXIST IN THE FIELD. IT IS IMPERATIVE THAT "U.S.A" LOCATING SERVICES LOCATE AND MARK UTILITIES PRIOR TO THE START OF EXCAVATION.
- THE CONTRACTOR SHALL USE EXTREME CAUTION WHEN EXPOSING EXISTING UTILITY CROSSINGS AND SERVICES. ANY DAMAGE TO EXISTING UTILITIES WILL BE THE SOLE RESPONSIBILITY OF THE CONTRACTOR.
- ANY DAMAGE TO EXISTING SIDEWALK, CURB OR GUTTER WILL BE THE SOLE RESPONSIBILITY OF THE CONTRACTOR, WITH REPLACEMENT TO BE DETERMINED BY THE ENGINEER.
- ALL SAWCUTS OR REMOVAL LIMITS SHALL BE MADE AT EXISTING EXPANSION OR WEAKENED PLANE JOINTS AND APPROVAL BY THE ENGINEER.
- THE CONTRACTOR SHALL PROVIDE AND INSTALL NEW G-05'S FOR ALL EXISTING MONUMENTS.
- EXCAVATION, GEO FABRIC INSTALL AND ROCK PLACEMENT SHALL TAKE PLACE IN 40' SEGMENTS. FULLY LOADED TRUCKS (I.E. "10-WHEELERS", "SUPERS", OR SIMILAR) SHALL NOT BE PERMITTED TO UTILIZE THE ACCESS ROAD BETWEEN START OF EXCAVATION AND FINISH OF ROCK PLACEMENT FOR EACH 40' SEGMENT. MATERIALS SHOULD BE STAGED APPROPRIATELY TO ACCOMMODATE THE LIMITED ACCESS. ANY SETTLING OR FAILURE OF THE ACCESS ROAD ASPHALT THAT OCCURS FROM UNAPPROVED TRUCK MOVEMENTS SHALL BE THE RESPONSIBILITY OF THE CONTRACTOR AND SHALL REQUIRE REMOVAL OF THE ACCESS ROAD AT THE LOCATION OF THE FAILURE, OVER EXCAVATION, AND COMPACTED BACKFILL.

LEGEND

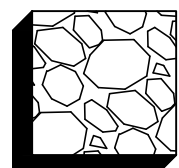

CALTRANS CLASS V - VII ROCK GRADATION  
(SEE BID QUANTITIES)

GEOTECHNICAL NOTES

- SEE ADDITIONAL DETAILING AND GEOTECHNICAL REPORTING, APPENDIX A.
- UNLESS OTHERWISE SPECIFIED, ALL MATERIALS AND INSTALLATION SHOULD CONFORM TO CALTRANS STANDARD SPECIFICATIONS, MOST RECENT EDITION.
- UNLESS OTHERWISE SPECIFIED, ALL MATERIALS AND INSTALLATION SHOULD CONFORM TO CALTRANS STANDARD SPECIFICATIONS, MOST RECENT EDITION.
- LOOSE SOIL AND VEGETATION PRESENT IN THE PROJECT AREA SHOULD BE EXCAVATED AND REMOVED FROM THE SITE.
- TEMPORARY EXCAVATIONS ARE THE RESPONSIBILITY OF THE CONTRACTOR AND, AS A MINIMUM, SHOULD CONFORM TO CAL OSHA CURRENT STANDARDS.
- THE SPECIFIED RSP SIZE, PLACEMENT METHOD, AND CONSTRUCTION SHOULD BE IN CONFORMANCE WITH CALTRANS STANDARD SPECIFICATIONS (LATEST EDITION), AND CALTRANS 2019 MEMORANDUM REGARDING RSP DESIGN.
- RSP SHOULD BE PLACED BY CALTRANS METHOD A PLACEMENT (SECTION 72-2.03B "ROCK SLOPE PROTECTION-PLACEMENT METHOD A").
- TO REDUCE POTENTIAL FOR SETTLEMENT AND/OR RSP READJUSTMENT, VOIDS CAN BE INFILLED WITH GRANULAR AGGREGATE, SUCH AS ¾-INCH CRUSHED ROCK OR SOIL AFTER EACH LIFT.

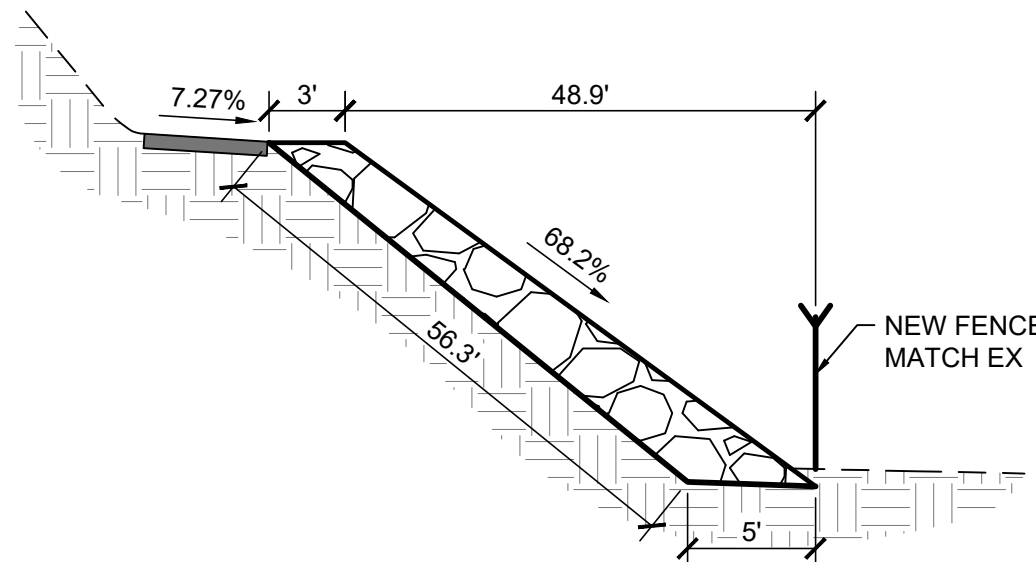

B-B CROSS SECTION  
NOT TO SCALE

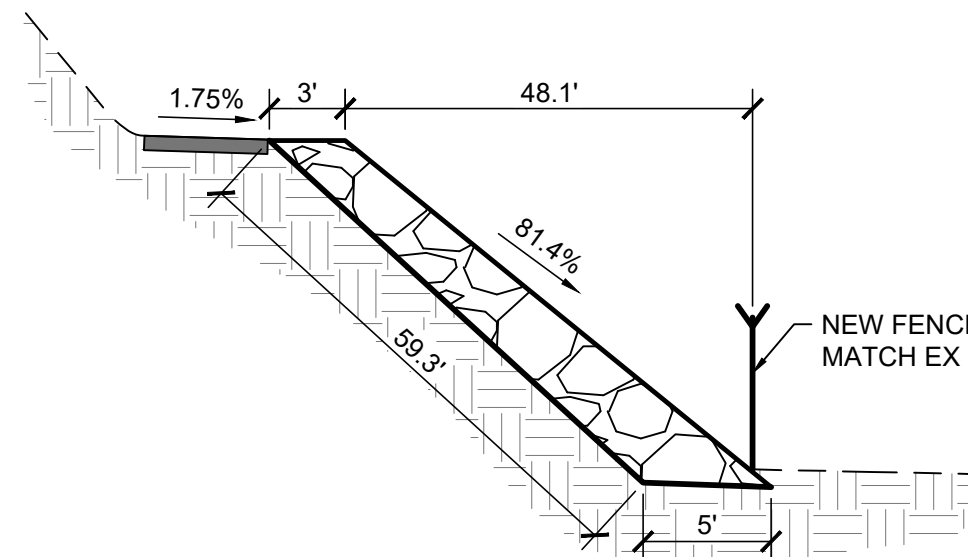

C-C CROSS SECTION  
NOT TO SCALE

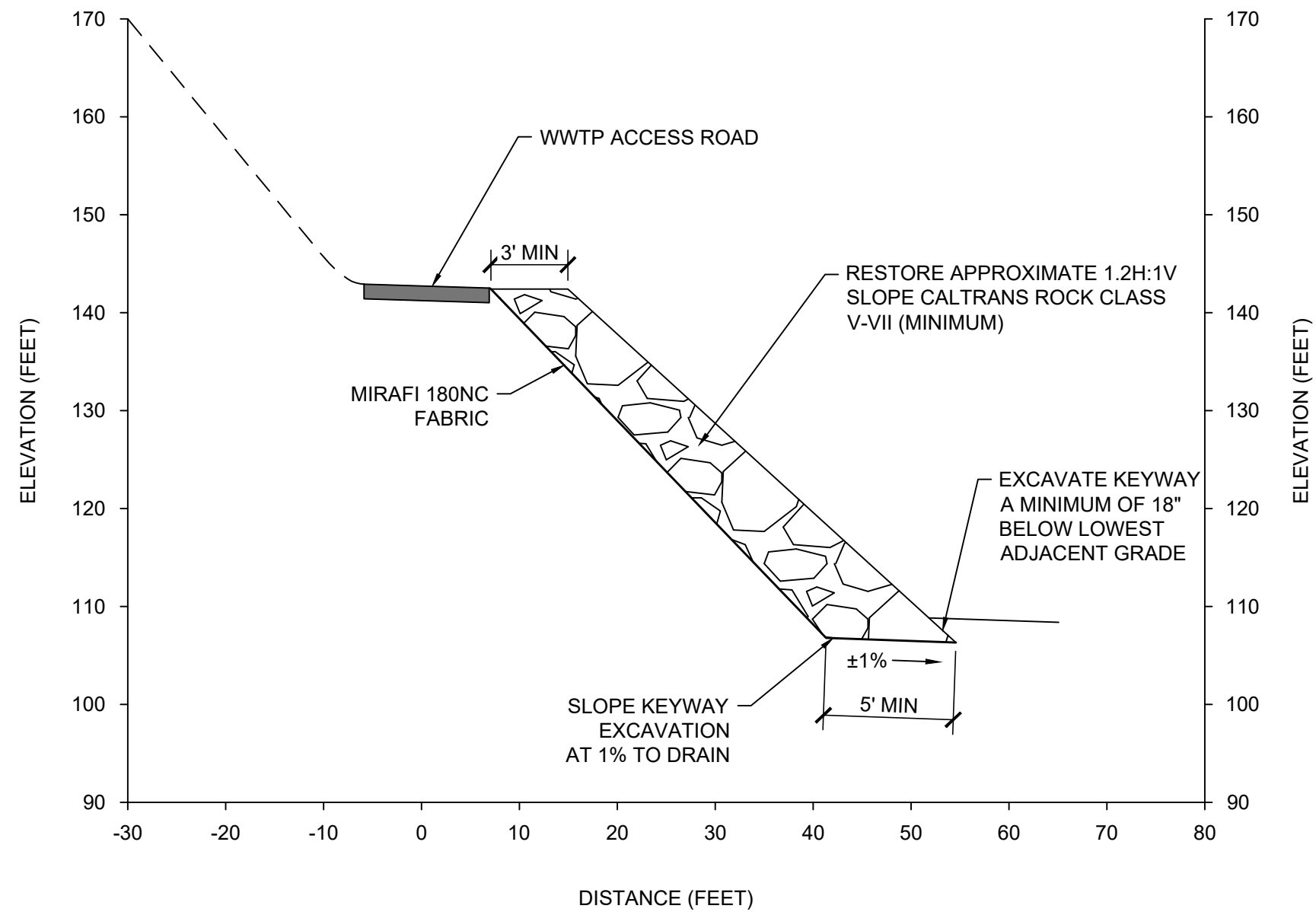

1 TYPICAL RSP MITIGATION  
NOT TO SCALE



Know what's below.  
Call before you dig.  
811 / 800-227-2600

PLAN REVISIONS		DATE
NO	DESCRIPTIONS	
1		
2		
3		
4		
5		
6		
7		
8		
9		
10		

JOB NO. 23-01	DATE 5/16/2024
SCALE AS SHOWN	DR BY NS
CK BY RM	FILE: WaterfordPublic23-01

GRADING PLAN

WWTP ROAD STABILIZATION

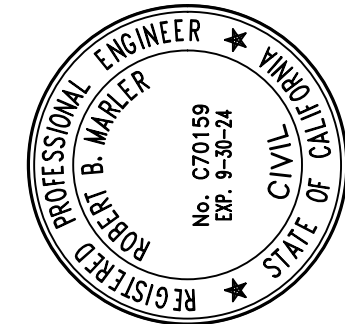





EROSION CONTROL PLAN

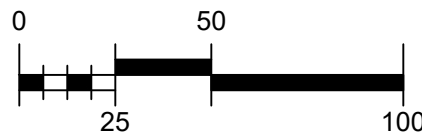
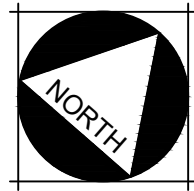

EROSION CONTROL NOTES

- EROSION AND SEDIMENT CONTROL MEASURES SHALL BE EFFECTIVE FOR THE DURATION OF THE CONSTRUCTION ACTIVITY.
- EROSION CONTROL BEST MANAGEMENT PRACTICES (BMPs) SHALL BE INSTALLED AND MAINTAINED DURING THE WET SEASON (OCTOBER 1 THROUGH APRIL 30). SEDIMENT CONTROL BMPs SHALL BE INSTALLED AND MAINTAINED YEAR ROUND.
- EFFECTIVE EROSION CONTROL BMPs SHALL BE IN PLACE PRIOR TO ANY STORM EVENTS.
- THE NAME, ADDRESS AND 24-HOUR TELEPHONE NUMBER OF THE PERSON RESPONSIBLE FOR IMPLEMENTATION OF THE EROSION AND SEDIMENTATION CONTROL PLAN SHALL BE PROVIDED.
- ALL DRAINAGE INLETS IMMEDIATELY DOWNSTREAM OF THE WORK AREAS AND WITHIN THE WORK AREAS SHALL BE PROTECTED WITH SEDIMENT CONTROL AND INLET FILTER BAGS YEAR ROUND. INLET FILTER BAGS SHALL BE REMOVED FROM THE DRAINAGE INLETS UPON COMPLETION OF CONSTRUCTION.
- THE CONTRACTOR(S) SHALL KEEP ALL PUBLIC ROADWAYS ADJACENT TO THE PROJECT SITE FREE AND CLEAR OF MUD AND SILT DURING THE TERM OF THIS CONTRACT. THIS INCLUDES MUD CAUSED BY RAIN OR BY THE CONTRACTOR(S) WATERING PROCEDURES FOR DUST CONTROL.
- ALL STABILIZED CONSTRUCTION ACCESS LOCATIONS SHALL BE CONSTRUCTED WHERE CONSTRUCTION TRAFFIC ENTERS OR LEAVES PAVED AREAS. THE STABILIZED ACCESS SHALL BE MAINTAINED ON A YEAR ROUND BASIS UNTIL THE COMPLETION OF CONSTRUCTION.
- WHEN NECESSARY, WHEELS SHALL BE CLEANED TO REMOVE SEDIMENT PRIOR TO ENTRANCE ONTO PUBLIC RIGHT-OF-WAY. WHEN WASHING IS REQUIRED, IT SHALL BE DONE ON AN AREA STABILIZED WITH CRUSHED ROCK THAT DRAINS INTO AN APPROVED SEDIMENT TRAP OR BASIN. ALL SEDIMENT SHALL BE PREVENTED FROM ENTERING ANY STORM DRAIN, DITCH, OR WATERCOURSE THROUGH USE OF SANDBAGS, GRAVEL, BOARDS, OR OTHER APPROVED METHODS.
- SEDIMENT CONTROL BMPs SHALL BE PLACED ALONG THE PROJECT PERIMETER WHERE DRAINAGE LEAVES THE PROJECT. SEDIMENT CONTROL BMPs SHALL BE MAINTAINED YEAR ROUND UNTIL THE CONSTRUCTION IS COMPLETE OR THE DRAINAGE PATTERN HAS BEEN CHANGED AND NO LONGER LEAVES THE SITE.
- ALL EROSION AND SEDIMENTATION CONTROL MEASURES SHALL BE MAINTAINED UNTIL DISTURBED AREAS ARE STABILIZED. CHANGES TO THE EROSION AND SEDIMENTATION CONTROL PLAN SHALL BE MADE TO MEET FIELD CONDITIONS, BUT ONLY WITH THE APPROVAL OF OR AT THE DIRECTION OF THE CITY ENGINEER.
- DURING THE RAINY SEASON ALL SIDEWALK AND PAVED AREAS SHALL BE KEPT CLEAR OF EARTH MATERIAL AND DEBRIS. THE SITE SHALL BE MAINTAINED SO AS TO MINIMIZE SEDIMENT LADEN RUNOFF FROM ENTERING ANY STORM DRAINAGE SYSTEM.
- THE EROSION AND SEDIMENTATION CONTROL PLAN COVERS ONLY THE FIRST WINTER DURING WHICH CONSTRUCTION IS TO TAKE PLACE. PLANS ARE TO BE RESUBMITTED PRIOR TO SEPTEMBER 1 OF EACH SUBSEQUENT YEAR UNTIL THE CITY ACCEPTS THE SITE IMPROVEMENTS.
- IT IS THE RESPONSIBILITY OF THE CONTRACTOR TO INSPECT AND REPAIR ALL EROSION CONTROL FACILITIES AT THE END OF EACH WORK DAY DURING THE RAINY SEASON.
- IT IS THE RESPONSIBILITIES OF THE CONTRACTOR TO PROTECT TEMPORARY BORROW AREAS AND/OR STOCKPILES WITH APPROPRIATE EROSION CONTROL MEASURES SATISFACTORY TO THE CITY ENGINEER.
- THE CLEANING OF PAVED STREETS, DURING AND AT THE COMPLETION OF CONSTRUCTION, SHALL BE PERFORMED WITH MECHANICAL SWEEPERS. THE USE OF WATER TRUCKS TO "WASH DOWN" THE STREET IS PROHIBITED.
- ALL MATERIALS STORED ON SITE SHALL HAVE PROPER ENCLOSURES AND/OR COVERINGS.
- CONTRACTOR SHALL PLACE FIBER ROLLS AROUND THE SITE PERIMETER. THE CONTRACTOR SHALL INSPECT AND REPAIR FIBER ROLLS AFTER EACH STORM EVENT AND REMOVE SEDIMENT WHEN NECESSARY. REMOVED SEDIMENT SHALL BE DEPOSITED TO AN AREA THAT WILL NOT CONTRIBUTE TO SEDIMENT RUN-OFF AND CAN BE PERMANENTLY STABILIZED.
- NO ON-SITE FUELING SHALL TAKE PLACE.
- THE CONTRACTOR SHALL KEEP THE WORK SITE FREE AND CLEAR OF RUBBISH AND DEBRIS.
- THROUGHOUT ALL PHASES OF CONSTRUCTION, INCLUDING SUSPENSION OF WORK, AND UNTIL FINAL ACCEPTANCE OF THE PROJECT, THE CONTRACTOR SHALL KEEP THE PREMISES OCCUPIED BY HIM IN A CLEAN AND ORDERLY CONDITION, DISPOSING OF REFUSE AND LITTER IN A MANNER SATISFACTORY TO THE CITY.
- THE FOLLOWING PLANS ARE ACCURATE FOR EROSION CONTROL PURPOSES ONLY.
- THE INFORMATION ON THIS PLAN IS INTENDED TO BE USED AS A GUIDELINE FOR THE CONTRACTOR AND SUBCONTRACTORS TO COMPLY WITH THE REQUIREMENTS OF THE STATE WATER RESOURCES CONTROL BOARD. FIELD CONDITIONS MAY NECESSITATE MODIFICATIONS TO THIS PLAN.

NOTE

PROVIDE GRAVEL BAGS AND INLET PROTECTION AT NEAREST DOWNSTREAM CURB INLET ON EACH CROSS STREET.

LEGEND

- STABILIZED CONSTRUCTION ENTRANCE TC-1
- FIBER ROLLS SC-5
- SAND BAG BARRIER SC-8
- PROVIDE STORM DRAIN INLET SEDIMENT PROTECTION SC-10
- TYPE 3 BARRICADES WITH "ROAD CLOSED" SIGN
- DESIGNATED CONSTRUCTION DEBRIS AREA (UTILIZE WATER- TIGHT DUMPSTERS FOR SOLIDS)
- WM-8 VEHICLE AND EQUIPMENT MAINTENANCE AREA NS-10
- DESIGNATED AGGREGATE AND CONCRETE RINSE AREA WM-8
- DESIGNATED WASH DOWN AREA NS-8



Know what's below.  
Call before you dig.  
811 / 800-227-2600

EROSION CONTROL PLAN

WWTP ROAD STABILIZATION

WATERFORD,

CALIFORNIA

JOB NO. 23-01  
DATE 5/16/2024  
SCALE AS SHOWN  
DR BY NS  
CK BY RM  
FILE: WaterfordPublic23-01

PLAN REVISIONS	
NO	DESCRIPTIONS
1	
2	
3	
4	
5	
6	
7	
8	
9	
10	

**mcr**  
ENGINEERING  
w w m c r e n g c o  
PREPARED UNDER THE DIRECTION OF:  
ROBERT B. MARLER R.C.E. C70159 EXP. 9-30-24  
MCR ENGINEERING, INC.  
1242 DUPONT COURT  
MANTECA, CA 95336  
TEL : (209) 239-6229  
FAX : (209) 239-8839

PUBLIC WORKS PROJECT  
CITY OF WATERFORD  
320 E STREET WATERFORD, CA 95366  
PROFESSIONAL ENGINEER  
ROBERT B. MARLER  
No. C70159  
Exp. 9-30-24  
STATE OF CALIFORNIA  
CIVIL  
DATE

SHEET

5

OF 5 SHEETS